

LAG SCREW SHIELD ANCHOR

F

Lag Screw Shield Anchors are designed for light to medium-duty fastening into concrete, brick, or block. They are made of rustproof zinc alloy and work with lag screws to provide strong holding power. The anchor expands as the screw is tightened, creating a secure hold in the base material. A short shield is recommended for harder concrete to minimize drilling time, while a long shield is ideal for softer masonry for maximum holding power.

Function

- Available in short or long length.
- Expand as lag screw is fastened through the anchor.
- Consist of pre-assembled two-part expansion shields.
- Manufactured from corrosion-resistant zinc alloy.
- Precisely tapered internal threading for easy screw installation.

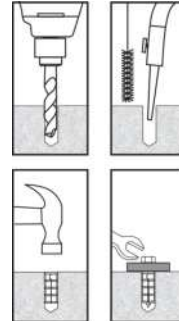

Part No.	Size	Shield Length (mm)	Drill Hole Diameter (mm)	Screw Size (mm)	Min. Embedment (mm)	Pull-Out Strength* (kN)	Shear Strength* (kN)
IC402081230	12	30	12	8-10	30	3	4.5
IC402081250	12	50	12	8-10	50	4.5	6
IC402081638	16	38	16	12-14	38	5	7.5
IC402081665	16	65	16	12-14	65	6.5	9
IC402082050	20	50	20	16	50	7	10.5
IC402082080	20	80	20	16	80	9	12